

DC Motor 38ZY

Standard Data

	12V	24V
Model (order reference)	38ZYT124000	38ZYT244000
Rated voltage	12VDC	24VDC
Operating voltage range	10VDC...14VDC	22VDC...26VDC

Shaft dimension	Ø5,0 x 20mm
Weight	0,25Kg
Dimension	Ø38 x 64 mm
Ambient temperature	-15...+60°C
Storage temperature	-20...+85°C
Mounting	any
Lead wire lengths	190mm +/-10



Performance Data

No load current [A]	0,35	0,25
No load speed [rpm]	4000 +/-10%	4000 +/-10%
Rated Current [A]	1,05	0,6
Rated speed [rpm]	2700 +/-10%	2800 +/-10%
Rated torque [mNm]	30	30
Rated power [W]	8,5	9
Continuous torque [mNm]	19	22
Stall torque [mNm]	102	108
All values measured at	20°C	20°C

Performance Curve

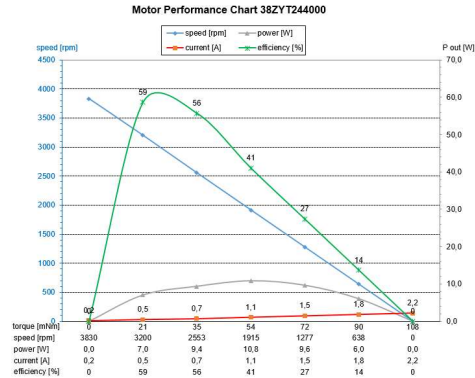
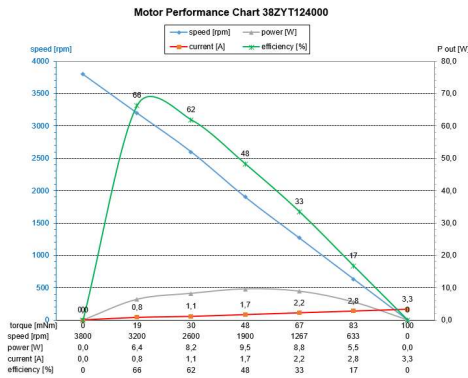

Dimension

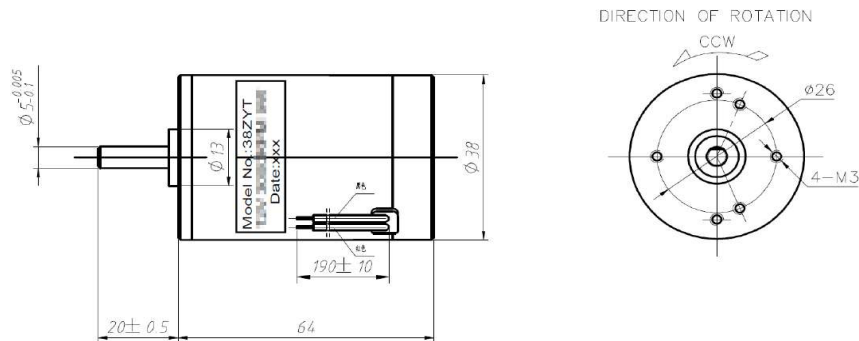

DC Motor 50ZY

Standard Data

	12V	24V
Model ((order reference)	50ZYT124500	50ZYT244500
Rated voltage	12VDC	24VDC
Operating voltage range	10VDC...14VDC	22VDC...26VDC
Shaft dimension	Ø6,0 x 25mm	
Weight	0,50Kg	
Dimension	Ø50 x 88 mm	
Ambient temperature	-15...+60°C	
Storage temperature	-20...+85°C	
Mounting	any	
Lead wire lengths	190mm +/-10	



Performance Data

No load current [A]	0,4	0,25
No load speed [rpm]	4500 +/-10%	4500 +/-10%
Rated current [A]	6,8	3,7
Rated speed [rpm]	3200 +/-10%	3250 +/-10%
Rated torque [mNm]	150	150
Rated power [W]	50	50
Continuous torque [mNm]	100	100
Stall torque [mNm]	530	540
All values measured at	20°C	20°C

Performance Curve

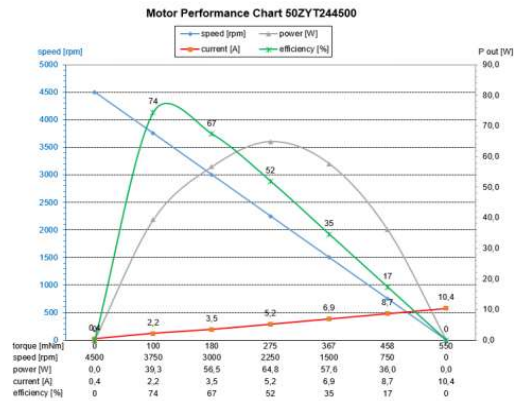
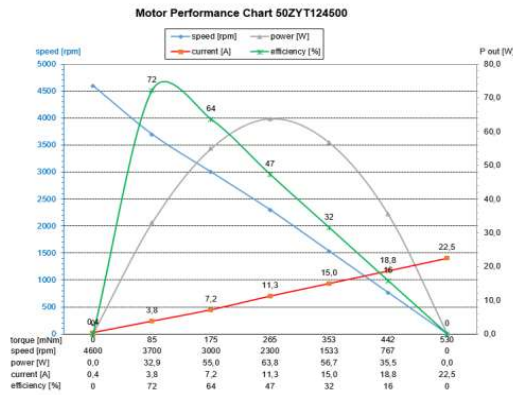

Dimension

