

## Hybrid stepper motor 23HS

### Standard Data

Model	23HS6404	23HS7404	23HS8404	23HS1404	23HS2404
Weight [g]	680	850	1050	1250	1400
Body lengths [mm]	56	64	76	100	112

### Performance Data

Rated Current [A]	4,2	4,2	4,2	4,2	4,2
Phase resistance [ $\Omega$ ]	0,4	0,55	0,5	0,8	0,9
Holding torque [cNm]	110	150	180	250	250
Detent torque [cNm]	3,5	5	6	10	12
Rotor inertia [gcm <sup>2</sup> ]	280	380	440	680	800

Shaft dimension	$\varnothing 6,35 \times 21\text{mm}$
Ambient temperature	-20...+50°C
Mounting	any
Lead wire lengths	300mm
Winding tpye	bipolar
Step angle	1,8°



### Wiring diagramm

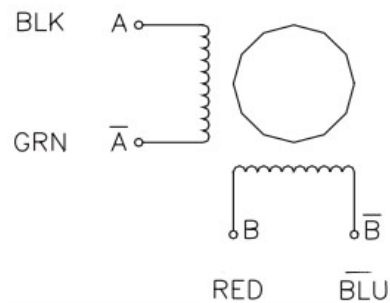

### Dimension

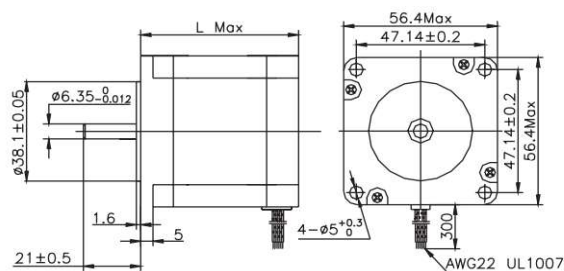

### Description:

Model	Motor Length
23HS0xxx	41mm
23HS4xxx	45mm
23HS5xxx	51mm
23HS6xxx	56mm
23HS7xxx	64mm
23HS8xxx	76mm
23HS1xxx	100mm
23HS2xxx	112mm